

NOTICE OF PROPOSED INSTALLATION  
PIPELINE AND/OR UTILITY LINES

TO: THE PANOLA COUNTY COMMISSIONER'S COURT

c/o

PANOLA COUNTY ROAD & BRIDGE DEPARTMENT, CARTHAGE, TEXAS

Formal notice is hereby given that:

Gill Water Supply Corp. proposes to place a  
(COMPANY NAME) Bore CR 309 with a 2" casing for a 1" water servi  
service. Bore will be appx 500ft from intersection of FM 1186  
Bore will be 3ft below ditch line. line within the Right-of-Way  
(PIPE SIZE)

of County Road: 309 as follows:  
(NUMBER OF ROAD)

The proposed pipeline will cross under the indicated roads on the attached sheet.  
Installation shall be made by boring a total length of 35ft line in Panola County.

The location and description of the proposed line and appurtenances is more fully shown  
by the copies of the drawings attached to this notice. The line will be constructed and  
maintained on the County Right-of-Way as directed by the County Commissioners in  
accordance with current Panola County Specifications.

Construction of this line will begin on or after the 10th day of  
December, 2018

FIRM: Gill Water Supply Corp.  
BY: Betty Bolt  
TITLE: Manager  
ADDRESS: 2323 FM 2625  
Marshall, Tx. 75672  
PHONE: (903) 938-5130

# APPROVAL

December 11, 2018

TO: Gill Water Supply Corp.  
Attn: Betty Bolt  
2323 FM 2625  
Marshall, Tx. 75672

RE: **CR #309**

The Panola County Commissioners' Court offers no objection to the location on the right-of-way of your proposed **2" casing for a 1" water service line** within the right-of-way of County Road **#309** as shown by accompanying drawings and notice except as noted below.

It is expressly understood that the County Commissioners' Court does not purpose hereby, to grant any right, claim, title or easement in or upon this county road. It is further understood that in the future should for any reason the county need to work, improve, relocate, widen, increase, add to, or in any manner change the structure of this right-of-way, any required relocation of said lines shall be at the sole expense of owner.

All work on the county right-of-way shall be performed in accordance with the county instructions. The installations shall not damage any part of the road and adequate provisions must be made to cause minimum inconvenience to traffic and adjacent owners. Special specifications for placing this line are as follows:

1. All lines are to be installed a minimum of 36 inches below the flow line of the adjacent drainage or barrow ditch.
2. All excavation within the right-of-way and not under surfacing shall be backfilled by tamping in 6 inch horizontal layers. All surplus material shall be removed from the right-of-way and the excavation finished flush with surrounding natural ground.
3. Lines crossing under surfaced roads and under surfacing cross roads within the right-of-way shall be placed by boring. Boring shall extend from crown line to crown line. Gravity from sewer lines under roadways shall be cast iron pipe.
4. All lines, where practicable, shall be located to cross roadbed at approximately right angles thereto. No lines are to be installed under or within 50 feet of either end of any bridge. No lines shall be placed in any culvert or within 10 feet of the closest point of same.

5. Parallel line will be installed as near the right-of-way lines as is possible and no parallel line will be installed in the roadbed or between the drainage ditch and the roadbed without special permission of the Panola County Commissioners' Court.
6. Operations along roadbeds shall be performed in such manner that all excavated material be kept off the pavement at all times, as well as all operating equipment and materials. No equipment or installation procedures will be used which will damage any road surface or structures. The cost of any repairs to road surface, roadbed, structures or other right-of-way features as a direct result of this installation will be borne by the owner of this line.
7. Barricades, warning signs, lights, and flag man(men) when necessary shall be provided by the contractor or owner. One-half (1/2) of the traveled portion of the road must be open at all times.

Approved:   
COUNTY JUDGE

COMMISSIONERS:

Precinct #1	Ronnie LaGrone
Precinct #2	John Gradberg
Precinct #3	Craig M. Lawless
Precinct #4	Dale LaGrone

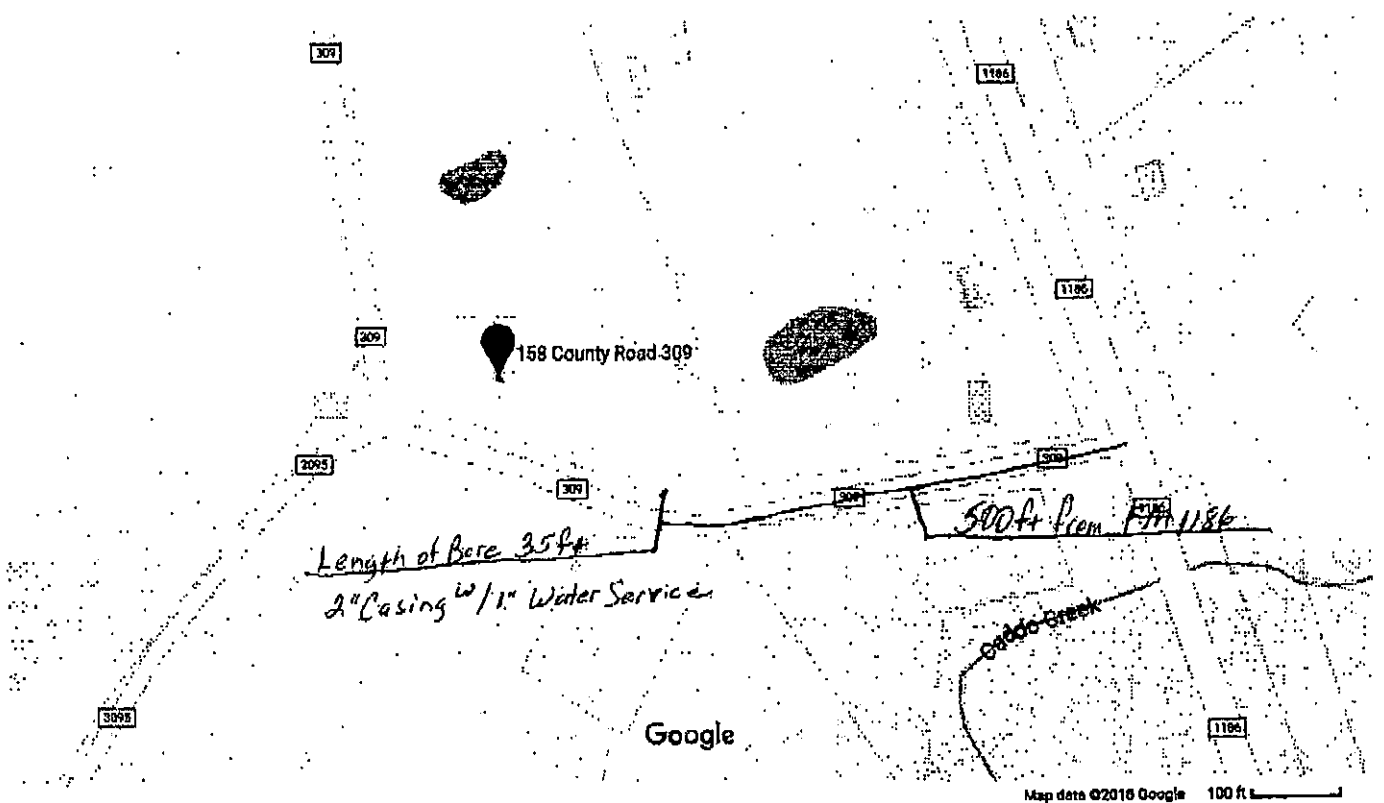

158 Co Rd 309  
De Berry, TX 75639



NOTICE OF PROPOSED INSTALLATION  
PIPELINE AND/OR UTILITY LINES

TO: THE PANOLA COUNTY COMMISSIONER'S COURT

c/o

PANOLA COUNTY ROAD & BRIDGE DEPARTMENT, CARTHAGE, TEXAS

Formal notice is hereby given that:

BTA ETh Gathering LLC proposes to place a  
(COMPANY NAME)

16" and 20" line within the Right-of-Way  
(PIPE SIZE)

of County Road: CR 401, CR 301 as follows:  
(NUMBER OF ROAD)

The proposed pipeline will cross under the indicated roads on the attached sheet.  
Installation shall be made by boring a total length of \_\_\_\_\_ line in Panola County.

The location and description of the proposed line and appurtenances is more fully shown  
by the copies of the drawings attached to this notice. The line will be constructed and  
maintained on the County Right-of-Way as directed by the County Commissioners in  
accordance with current Panola County Specifications.

Construction of this line will begin on or after the 15<sup>th</sup> day of  
February, 2018.

FIRM: BTA ETh Gathering LLC  
BY: Lee Harshbarger  
TITLE: Right of Way Supervisor  
ADDRESS: 419 W Sabine #2  
Carthage, TX 75633  
PHONE: (832) 643-5930

# APPROVAL

December 11, 2018

TO: BTA ETG Gathering LLC  
Attn: Lee Harugthy  
419 W. Sabine St., Suite #2  
Carthage, Tx. 75633

RE: **CR #301 & #401**

The Panola County Commissioners' Court offers no objection to the location on the right-of-way of your proposed **16" and 20" lines** within the right-of-way of County Roads **#301 & #401** as shown by accompanying drawings and notice except as noted below.

It is expressly understood that the County Commissioners' Court does not purpose hereby, to grant any right, claim, title or easement in or upon this county road. It is further understood that in the future should for any reason the county need to work, improve, relocate, widen, increase, add to, or in any manner change the structure of this right-of-way, any required relocation of said lines shall be at the sole expense of owner.

All work on the county right-of-way shall be performed in accordance with the county instructions. The installations shall not damage any part of the road and adequate provisions must be made to cause minimum inconvenience to traffic and adjacent owners. Special specifications for placing this line are as follows:

1. All lines are to be installed a minimum of 36 inches below the flow line of the adjacent drainage or barrow ditch.
2. All excavation within the right-of-way and not under surfacing shall be backfilled by tamping in 6 inch horizontal layers. All surplus material shall be removed from the right-of-way and the excavation finished flush with surrounding natural ground.
3. Lines crossing under surfaced roads and under surfacing cross roads within the right-of-way shall be placed by boring. Boring shall extend from crown line to crown line. Gravity from sewer lines under roadways shall be cast iron pipe.
4. All lines, where practicable, shall be located to cross roadbed at approximately right angles thereto. No lines are to be installed under or within 50 feet of either end of any bridge. No lines shall be placed in any culvert or within 10 feet of the closest point of same.
5. Parallel line will be installed as near the right-of-way lines as is possible and

no parallel line will be installed in the roadbed or between the drainage ditch and the roadbed without special permission of the Panola County Commissioners' Court.

6. Operations along roadbeds shall be performed in such manner that all excavated material be kept off the pavement at all times, as well as all operating equipment and materials. No equipment or installation procedures will be used which will damage any road surface or structures. The cost of any repairs to road surface, roadbed, structures or other right-of-way features as a direct result of this installation will be borne by the owner of this line.
7. Barricades, warning signs, lights, and flag man(men) when necessary shall be provided by the contractor or owner. One-half (1/2) of the traveled portion of the road must be open at all times.

Approved:   
COUNTY JUDGE

COMMISSIONERS:

Precinct #1	Ronnie LaGrone
Precinct #2	John Gradberg
Precinct #3	Craig M. Lawless
Precinct #4	Dale LaGrone

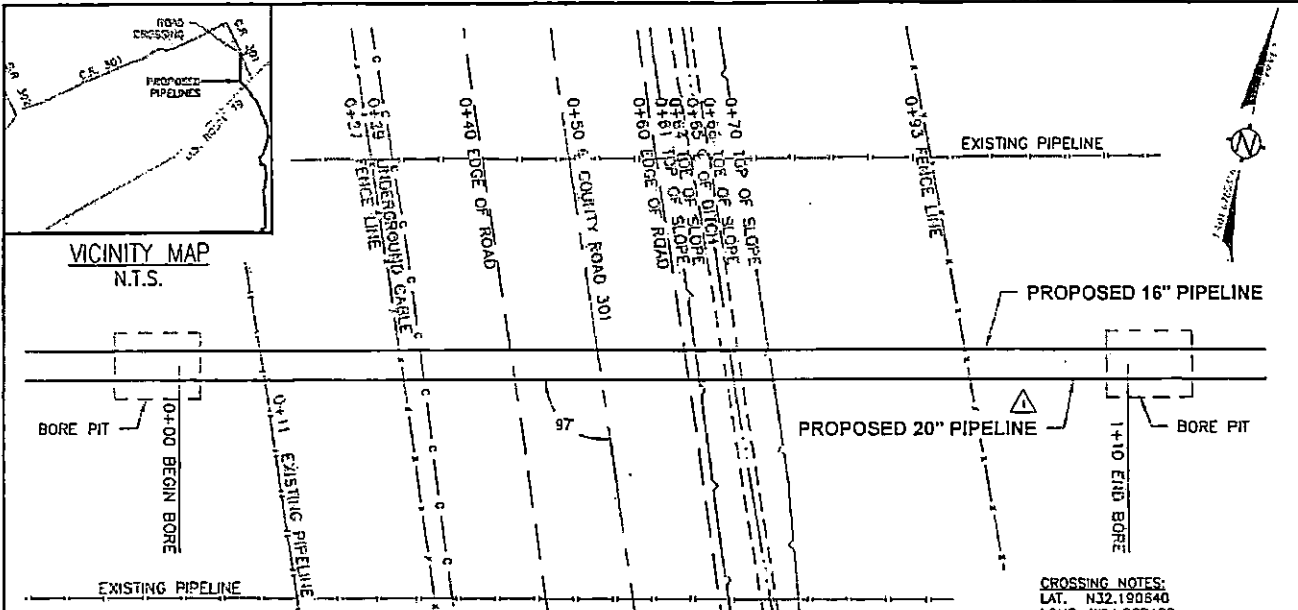

NO.	REVISIONS	BY	DATE
1	REVISED PIPELINE SIZE	R.WEBER	11/27/18

**PLAN**  
1"=20' HORIZONTAL

**CROSSING NOTES:**  
LAT. N32.190540  
LONG. W94.268465

**CLOSEST INTERSECTIONS**  
C.R. 302 2.96 MILES NORTH  
U.S. ROUTE 79 0.28 MILES SOUTH

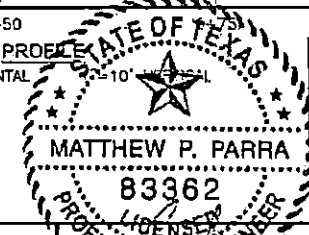
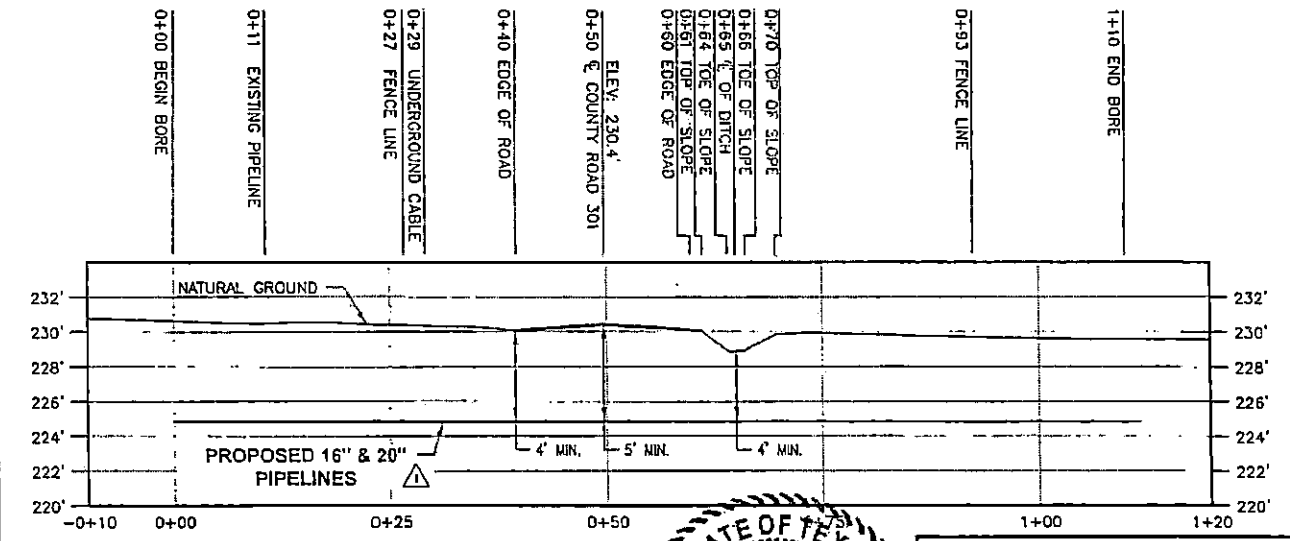

I, MATTHEW P. PARRA, AN INDEPENDENT CONSULTING ENGINEER, TEXAS REGISTERED ENGINEERING FIRM NUMBER 7272. A REGISTERED PROFESSIONAL ENGINEER IN THE STATE OF TEXAS, P.E. NUMBER 83362, DO HEREBY CERTIFY THAT TO THE BEST OF MY KNOWLEDGE AND BELIEF, THE PIPELINE CROSSING SHOWN ON THIS DRAWING HAS BEEN DESIGNED IN ACCORDANCE WITH THE CFR, TITLE 49, PART 192 - TRANSPORTATION OF NATURAL AND OTHER GAS BY PIPELINE, SUBPART C - DESIGN REQUIREMENTS AND API 1102 STEEL PIPELINES CROSSING RAILROADS AND HIGHWAYS.

- PIPE SPECIFICATIONS:**
1. PRODUCT: NATURAL GAS
  2. CARRIER PIPE: 16.000" O.D. x 0.500" W.T., API 5L X-52 PSL2 PIPE W/15-22 MILS FBE & 30-40 MILS ARO COATING
  3. SEAM TYPE=ERW
  4. SEAM JOINT FACTOR=1.0
  5. MINIMUM TEST PRESSURE: 1,800 PSIG
  6. MAOP: 1,440 PSIG

- GENERAL NOTES:**
1. ALL COORDINATES, BEARINGS AND DISTANCES ARE REFERENCED TO THE TEXAS COORDINATE SYSTEM (NAD 83 - 4202), U.S. SURVEY FEET BASED ON GPS OBSERVATIONS MADE BY TABLEROCK SURVEY, LLC.
  2. PIPELINE WARNING SIGNS SHALL BE INSTALLED AT EACH RIGHT-OF-WAY LINE.
  3. ALL EXCAVATION AND BACKFILL SHALL BE IN ACCORDANCE WITH TxDOT ITEM 400. EXCAVATION BACKFILL FOR PIPELINES SHALL BE AS FOLLOWS:
    - 60 INCHES UNDER THE PAVEMENT SURFACE OR 18 INCHES UNDER PAVEMENT STRUCTURE IN PAVED AREAS; OR
    - 48 INCHES IF THE LINE IS PLACED OUTSIDE THE PAVEMENT STRUCTURE OR UNDER THE FLOWLINE OF THE DITCH
  5. ALL TRENCH EXCAVATIONS DEEPER THAN 5' SHALL FOLLOW APPLICABLE STATE OF TEXAS AND O.S.H.A. SAFETY REGULATIONS.
  6. PIPELINE TO BE CATHODICALLY PROTECTED

- PIPE SPECIFICATIONS:**
1. PRODUCT: RESIDUE GAS
  2. CARRIER PIPE: 20.000" O.D. x 0.500" W.T., API 5L GRX-65 PL2 PIPE W/15-22 MILS FBE & 30-40 MILS ARO COATING
  3. SEAM TYPE=ERW
  4. SEAM JOINT FACTOR=1.0
  5. MINIMUM TEST PRESSURE: 1,800 PSIG
  6. MAOP: 1,440 PSIG

**BTA ETG  
GATHERING LLC**

**TABLEROCK  
SURVEY, LLC**  
2204 TIMBERLOCH PL., STE. 150  
THE WOODLANDS, TX 77380  
OFFICE: 832-415-3869  
TRPLS FIRM NO. 10184261

TEMPLATE REV. 20180130
TRACY NUMBER: TX-FN-0101.0001D
PROJ. NAME: PANOLA GAS GATHERING
PROJ. NO: 1804-03118
SURVEY DATE: 6/04/18
DRAWN BY: R.WEBER
CHECKED BY: M.P.PARRA
DRAWN DATE: 6/25/18
PAGE: 1 OF 1

**PERMIT DRAWING**  
**PANOLA GAS GATHERING PIPELINE**  
**COUNTY ROAD 301**  
**PANOLA COUNTY, TEXAS**



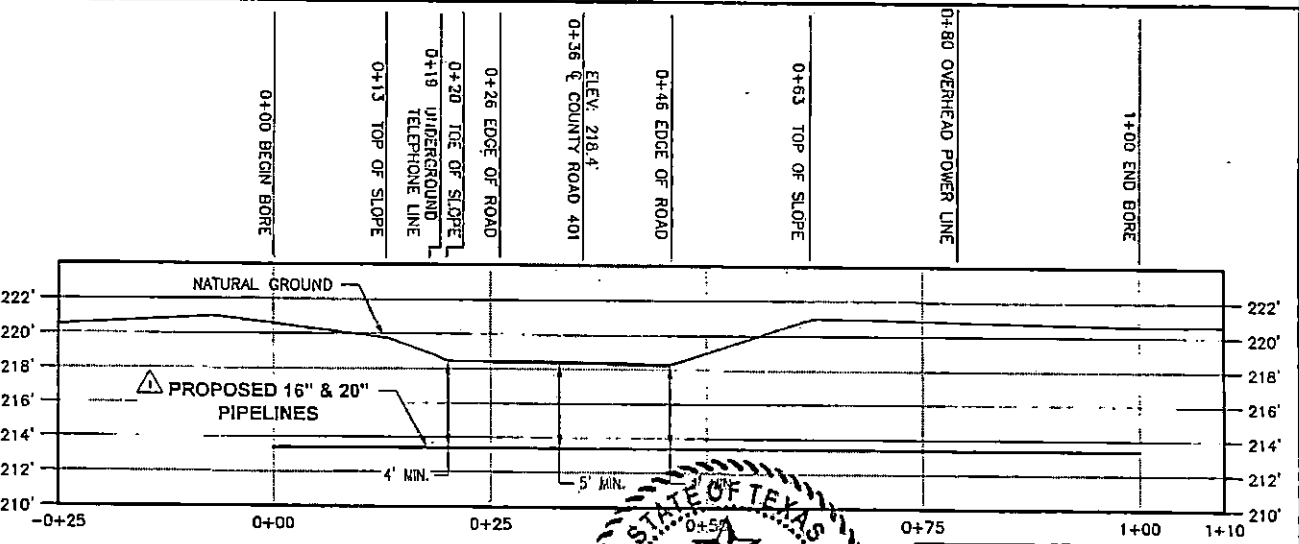
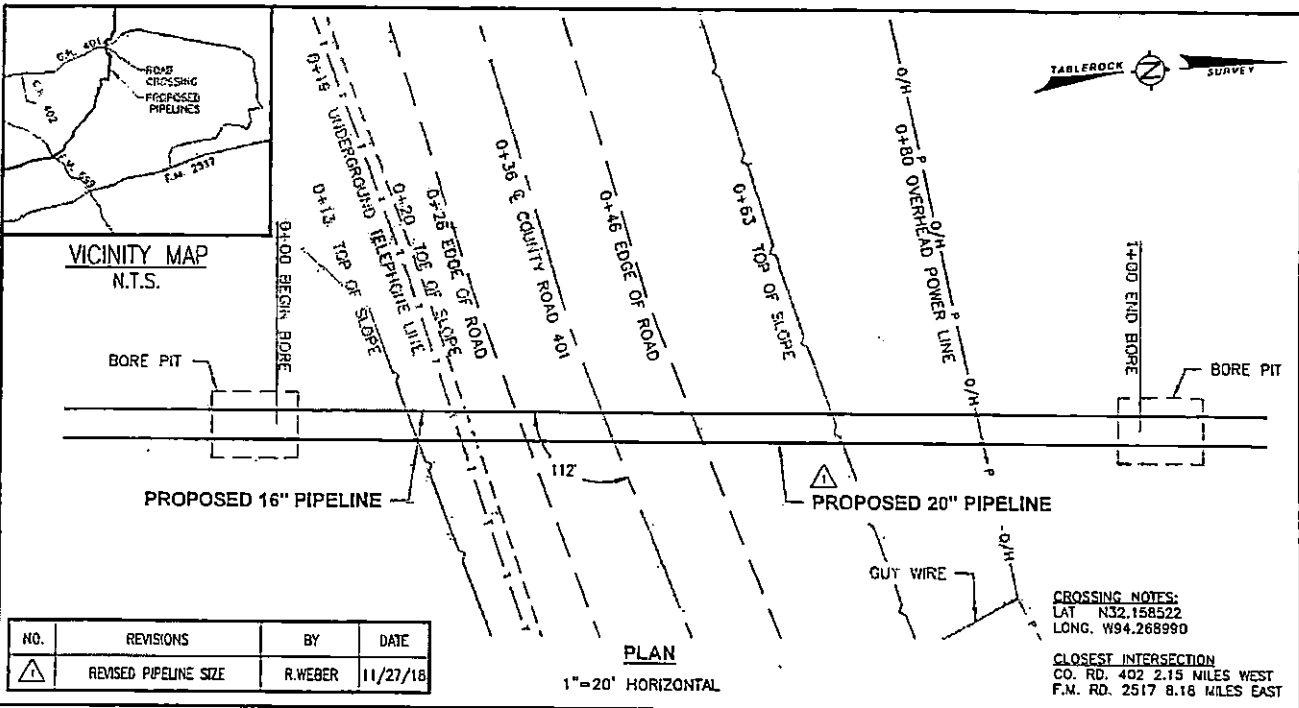

I, MATTHEW P. PARRA, AN INDEPENDENT CONSULTING ENGINEER, TEXAS REGISTERED ENGINEERING FIRM NUMBER 7272. A REGISTERED PROFESSIONAL ENGINEER IN THE STATE OF TEXAS, P.C. NUMBER 83362, DO HEREBY CERTIFY THAT TO THE BEST OF MY KNOWLEDGE AND BELIEF, THE PIPELINE CROSSING SHOWN ON THIS DRAWING HAS BEEN DESIGNED IN ACCORDANCE WITH THE CFR, TITLE 49, PART 192 - TRANSPORTATION OF NATURAL AND OTHER GAS BY PIPELINE, SUBPART C - DESIGN REQUIREMENTS AND API 1102 STEEL PIPELINES CROSSING RAILROADS AND HIGHWAYS.

- GENERAL NOTES:**
- ALL COORDINATES, BEARINGS AND DISTANCES ARE REFERENCED TO THE TEXAS COORDINATE SYSTEM OF 1983 (2011 ADJUSTMENT), NORTH CENTRAL ZONE (4202), U.S. SURVEY FEET BASED ON GPS OBSERVATIONS MADE BY TABLEROCK SURVEY, LLC.
  - PIPELINE WARNING SIGNS SHALL BE INSTALLED AT EACH RIGHT-OF-WAY LINE.
  - ALL EXCAVATION AND BACKFILL SHALL BE IN ACCORDANCE WITH TxDOT ITEM 400, "EXCAVATION BACKFILL FOR STRUCTURES".
  - FOR UNENCASED HIGH-PRESSURE GAS OR LIQUID PETROLEUM LINES, THE MINIMUM DEPTH OF COVER IS AS FOLLOWS:
    - 60 INCHES UNDER THE PAVEMENT SURFACE OR 18 INCHES UNDER PAVEMENT STRUCTURE IN PAVED AREAS; OR
    - 48 INCHES IF THE LINE IS PLACED OUTSIDE THE PAVEMENT STRUCTURE OR UNDER THE FLOWLINE OF THE DITCH
  - ALL TRENCH EXCAVATIONS DEEPER THAN 5' SHALL FOLLOW APPLICABLE STATE OF TEXAS AND O.S.H.A. SAFETY REGULATIONS.
  - PIPELINE TO BE CATHODICALLY PROTECTED.

- PIPE SPECIFICATIONS:**
- PRODUCT: NATURAL GAS
  - CARRIER PIPE: 16.000" O.D. x 0.500" W.T., API 5L X-52 PSL2 PIPE W/15-22 MILS FBE & 30-40 MILS ARO COATING
  - SEAM TYPE=ERW
  - SEAM JOINT FACTOR=1.0
  - MINIMUM TEST PRESSURE: 1,800 PSIG
  - MAOP: 1,440 PSIG

- PIPE SPECIFICATIONS:**
- PRODUCT: RESIDUE GAS
  - CARRIER PIPE: 20.000" O.D. x 0.500" W.T., API 5L GRX-65 PL2 PIPE W/15-22 MILS FBE & 30-40 MILS ARO COATING
  - SEAM TYPE=ERW
  - SEAM JOINT FACTOR=1.0
  - MINIMUM TEST PRESSURE: 1,800 PSIG
  - MAOP: 1,440 PSIG

**BTA ETG**  
**GATHERING LLC**

**TABLEROCK**  
SURVEY, LLC  
2204 TIMBERLOCH PL., STE. 150  
THE WOODLANDS, TX 77380  
OFFICE: 832-415-3869  
TBPLS FIRM NO. 10194261

TEMPLATE REV: 20180130
SPACT NUMBER: TX-PH-C09320010
PROJ. NAME: PANOLA GAS GATHERING
PROJ. NO: 1804-C0115
SURVEY DATE: 06/01/18
DRAWN BY: R.RANBYN
DRAWN DATE: 06/20/18
PAGE: 1 OF 1

**PERMIT DRAWING**  
**PANOLA GAS GATHERING PIPELINE**  
**COUNTY ROAD 401**  
**PANOLA COUNTY, TEXAS**

**PANOLA COUNTY INVESTMENT REPORT  
SEPTEMBER 30, 2018**

INVESTMENTS AS OF JUNE 30, 2018	57,200,000.00		
		<b>Investments</b>	<b>Maturity</b>
			<b>Int. Rate</b>
Beginning Balance 07/01/2018	57,200,000.00		
Matured 07/12/2018 (Purchased on 04/12/2018)	(6,400,000.00)		
Matured 07/12/2018 (Purchased on 04/12/2018)	(10,200,000.00)		
<b>Purchase of CD No. 21304402470 on 07/12/2018</b>	7,000,000.00	10/11/2018	1.925%
General	2,961,000.00		
Law Library	19,000.00		
Courthouse Security	58,000.00		
Records Management	1,000.00		
CC Records Preservation	118,000.00		
Archive	17,000.00		
Justice Court Technology	20,000.00		
Road & Bridge	1,800,000.00		
FM & Lateral Road	690,000.00		
Hot Check Fee	6,000.00		
Sheriff's State Forfeiture	7,000.00		
DA State Forfeiture	-		
Child Protective Services	23,000.00		
Health Fund	1,043,000.00		
Airport	38,000.00		
Road Bond 1971	78,000.00		
Permanent Improvement	62,000.00		
Jail Improvements	59,000.00		
<b>Purchase of CD No. 21304402471 on 07/12/2018</b>	10,300,000.00	10/11/2018	1.925%
Retiree Health Benefit Trust	10,300,000.00		
Matured 08/16/2018 (Purchased on 05/17/2018)	(10,100,000.00)		
Matured 08/16/2018 (Purchased on 05/17/2018)	(9,600,000.00)		
<b>Purchase of CD No. 21304402483 on 08/16/2018</b>	6,600,000.00	11/15/2018	2.020%
General	2,896,000.00		
Law Library	16,000.00		
Courthouse Security	59,000.00		
Records Management	3,000.00		
CC Records Preservation	89,000.00		
Archive	16,000.00		
Justice Court Technology	21,000.00		
Road & Bridge	1,600,000.00		
FM & Lateral Road	550,000.00		
Hot Check Fee	7,000.00		
Sheriff's State Forfeiture	9,000.00		
DA State Forfeiture	-		
Child Protective Services	20,000.00		
Health Fund	1,112,000.00		
Airport	10,000.00		
Road Bond 1971	75,000.00		
Permanent Improvement	60,000.00		
Jail Improvements	57,000.00		
<b>Purchase of CD No. 21304402484 on 08/16/2018</b>	10,200,000.00	11/15/2018	2.020%
Retiree Health Benefit Trust	10,200,000.00		
Matured 09/13/2018 (Purchased on 06/14/2018)	(10,200,000.00)		
Matured 09/13/2018 (Purchased on 06/14/2018)	(10,400,000.00)		
Matured 09/13/2018 (Purchased on 06/14/2018)	(100,000.00)		
Matured 09/13/2018 (Purchased on 06/14/2018)	(200,000.00)		
<b>Purchase of CD No. 21304402493 on 09/13/2018</b>	9,227,000.00	12/13/2018	2.103%
General	4,200,000.00		
Law Library	18,000.00		
Courthouse Security	67,000.00		
Records Management	2,000.00		
CC Records Preservation	105,000.00		
Archive	20,000.00		
Justice Court Technology	23,000.00		
Road & Bridge	2,700,000.00		
FM & Lateral Road	700,000.00		
Hot Check Fee	5,000.00		
SO State Forfeiture	6,000.00		
DA State Forfeiture	4,000.00		
Child Protective Services	21,000.00		
Health Fund	1,117,000.00		
Airport	49,000.00		
Road Bond 1971	76,000.00		
Permanent Improvement	58,000.00		
Jail Improvements	56,000.00		
<b>Purchase of CD No. 21304402494 on 09/13/2018</b>	10,400,000.00	12/13/2018	2.103%
Retiree Health Benefit Trust	10,400,000.00		
<b>Purchase of CD No. 21304402495 on 09/13/2018</b>	200,000.00	12/13/2018	2.103%
Panola Juvenile Probation	10,000.00		
Title IV-E	70,000.00		
Local Match Juvenile Probation	120,000.00		
<b>Purchase of CD No. 21304402496 on 09/13/2018</b>	100,000.00	12/13/2018	2.103%
Adult Probation	100,000.00		
INVESTMENTS AS OF SEPTEMBER 30, 2018	54,027,000.00		

THE MARKET VALUE OF ALL INVESTMENTS IS THE SAME AS CARRYING VALUE.

To the best of our knowledge and belief, the transactions reflected in this investment report are in compliance with the investment policy of PANOLA COUNTY and conform to the requirements of the PUBLIC FUNDS INVESTMENT ACT.

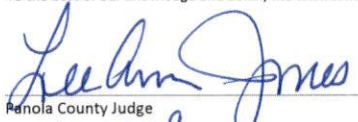
  
 Panola County Judge  
 12-11-18  
 Date

  
 Panola County Auditor  
 12-11-18  
 Date

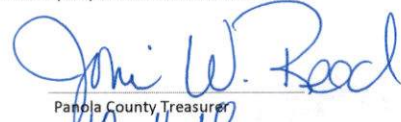
  
 Panola County Treasurer  
 12-11-18  
 Date



**PANOLA COUNTY 2018 BUDGET AMENDMENT #23  
December 11, 2018**

ACCOUNT	ACCOUNT DESCRIPTION	AMOUNT	
<b>GENERAL FUND</b>			
<b>REVENUES</b>			
<a href="#">100-360-41020</a>	MISCELLANEOUS REVENUE	28,925	
			<u>28,925</u>
<b>EXPENDITURES</b>			
<b>MISC. &amp; NON-DEPARTMENTAL</b>			
<a href="#">100-409-52010</a>	SOCIAL SECURITY	1,500	
<a href="#">100-409-52030</a>	RETIREMENT & DEATH BENEFITS	4,000	
<a href="#">100-409-52070</a>	OTHER POST EMPLOYMENT BENEFITS	2,800	
			<u>8,300</u>
<b>COUNTY COURT AT LAW</b>			
<a href="#">100-426-53120</a>	LAW BOOKS	310	
<a href="#">100-426-55270</a>	FURNITURE & EQUIPMENT	(310)	
			0
<b>JUSTICE OF PEACE PCT 1 &amp; 4</b>			
<a href="#">100-455-54260</a>	TRAVEL	200	
<a href="#">100-455-54270</a>	CONFERENCES AND DUES	(200)	
<a href="#">100-455-54990</a>	MISCELLANEOUS	(200)	
<a href="#">100-455-55270</a>	FURNITURE & EQUIPMENT	200	
			0
<b>JUSTICE OF PEACE PCT 2 &amp; 3</b>			
<a href="#">100-457-54260</a>	TRAVEL	(550)	
<a href="#">100-457-55270</a>	FURNITURE & EQUIPMENT	550	
			0
<b>SHERIFF</b>			
<a href="#">100-560-54540</a>	PARTS REPAIRS GAS AND TRANS. E	(45,000)	
<a href="#">100-560-55270</a>	FURNITURE & EQUIPMENT	45,000	
			0
<b>CORRECTIONS/JAIL</b>			
<a href="#">100-570-53930</a>	MISCELLANEOUS SUPPLIES	9,000	
<a href="#">100-570-54082</a>	JAIL BOARD-PRISONERS FOOD ETC.	(4,500)	
<a href="#">100-570-54990</a>	MISCELLANEOUS	(3,425)	
<a href="#">100-570-55270</a>	FURNITURE & EQUIPMENT	7,925	
			<u>9,000</u>
<b>HEALTH &amp; PAUPERS CARE</b>			
<a href="#">100-646-54890</a>	ATTORNEY FEES	10,000	
<a href="#">100-646-54990</a>	MISCELLANEOUS	1,625	
			<u>11,625</u>

ACCOUNT	ACCOUNT DESCRIPTION	AMOUNT
---------	---------------------	--------

**AGRICULTURE EXTENSION SERVICE**

[100-665-53100](#)

OFFICE SUPPLIES & REPAIRS

100

[100-665-54260](#)

TRAVEL

(100)

0

**GRAND TOTAL GENERL FUND**

28,925

**ROAD & BRIDGE FUND**

**EXPENDITURES**

**PCT. 4**

[200-624-53560](#)

REPAIR AND MAINTENANCE SUPPLIES

8,000

[200-624-55270](#)

FURNITURE & EQUIPMENT

(16,000)

[200-624-55280](#)

ROAD OIL PRE MIX & GRAVEL

8,000

0

**GRAND TOTAL ROAD & BRIDGE FUND**

0

**PANOLA COUNTY  
2018  
BUDGET AMENDMENT #23**

We hereby amend the Panola County Budget for the Fiscal Year 2018 as set forth above according to the procedures outlined under Vernons Texas Codes Annotated Local Government Code, Chapter 111, Subchapter A Sections 111.010 (d), 111.0106, 111.0107, 111.0108. A copy of this Order is to be filed with the County Clerk and Attached to the Budget originally adopted for 2018.

Signed on this 11<sup>th</sup> day of December, 2018.

Lee Ann Jones  
County Judge

Ronni LaDus  
Commissioner Precinct # 1

Absent  
Commissioner Precinct # 2

Con M. J.  
Commissioner Precinct # 3

Dale LaDus  
Commissioner Precinct # 4

Passed and approved by the Commissioners Court of Panola County on the 11<sup>th</sup> day of December, 2018 as the same appears on file in the office of the County Clerk of Panola County.

Bobbie Davis by (Rakesia Bledsoe)  
County Clerk



PANOLA COUNTY OFFICIAL/EMPLOYEE  
REQUEST FOR ATTENDANCE  
AT A CONFERENCE

APPROVED

12-11-2018

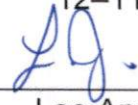

Lee Ann Jones,  
County Judge

NAME: Ronnie LaGrone

POSITION: County Commissioner

DEPARTMENT: Precinct # 1

DATE: 11-27-18

CONFERENCE: V.G. Young School for County Commissioners

LOCATION: College Station

DATES: February 19, 2019 to February 21, 2019

NUMBER OF DAYS OUT OF OFFICE FOR THIS CONFERENCE: 3

Does the conference meet your educational requirements for the year? Yes

If not, how much of your requirements will be met by this conference? -----

How much of your requirements have been met already, not counting this conference? N/A

How many days have you been away from your job this year for conferences, not counting this conference? None

Do you have sufficient funds in your budget for this conference? Yes

Write a short statement explaining the public purpose that will be met by your attendance at this conference: (continue on the back if necessary.)

Required by State in order to have educational requirements for the year.

---

---

---

---

---

---

---

---

PANOLA COUNTY OFFICIAL/EMPLOYEE  
REQUEST FOR ATTENDANCE  
AT A CONFERENCE

APPROVED

12-11-2018

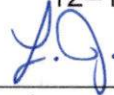

Lee Ann Jones,  
County Judge

NAME: David Cole

POSITION: County Commissioner Precinct #2

DEPARTMENT: Commissioner

DATE: 11-27-18

CONFERENCE: Newly Elected Judges & Commissioners

LOCATION: Austin

DATES: 01/14/19 to 01/17/19

NUMBER OF DAYS OUT OF OFFICE FOR THIS CONFERENCE: 4

Does the conference meet your educational requirements for the year? Yes

If not, how much of your requirements will be met by this conference? --

How much of your requirements have been met already, not counting this conference? None

How many days have you been away from your job this year for conferences, not counting this conference? -0-

Do you have sufficient funds in your budget for this conference? Yes

Write a short statement explaining the public purpose that will be met by your attendance at this conference: (continue on the back if necessary.)

Required by state in order to have educational requirements for the year.

---

---

---

---

---

---

PANOLA COUNTY OFFICIAL/EMPLOYEE  
REQUEST FOR ATTENDANCE  
AT A CONFERENCE

APPROVED

12-11-2018



Lee Ann Jones,  
County Judge

NAME: Craig Lawless

POSITION: County Commissioner

DEPARTMENT: Precinct # 3

DATE: 11-27-18

CONFERENCE: V.G. Young School for County Commissioners

LOCATION: College Station

DATES: February 19, 2019 to February 21, 2019

NUMBER OF DAYS OUT OF OFFICE FOR THIS CONFERENCE: 3

Does the conference meet your educational requirements for the year? Yes

If not, how much of your requirements will be met by this conference? -----

How much of your requirements have been met already, not counting this conference? N/A

How many days have you been away from your job this year for conferences, not counting this conference? None

Do you have sufficient funds in your budget for this conference? Yes

Write a short statement explaining the public purpose that will be met by your attendance at this conference: (continue on the back if necessary.)

Required by State in order to have educational requirements for the year.

---

---

---

---

---

---



PANOLA COUNTY OFFICIAL/EMPLOYEE  
REQUEST FOR ATTENDANCE  
AT A CONFERENCE

APPROVED

12-11-2018



Lee Ann Jones,  
County Judge

NAME: Dale LaGrone

POSITION: County Commissioner

DEPARTMENT: Precinct # 4

DATE: 11-27-18

CONFERENCE: V.G. Young School for County Commissioners

LOCATION: College Station

DATES: February 19, 2019 to February 21, 2019

NUMBER OF DAYS OUT OF OFFICE FOR THIS CONFERENCE: 3

Does the conference meet your educational requirements for the year? Yes

If not, how much of your requirements will be met by this conference? -----

How much of your requirements have been met already, not counting this conference? N/A

How many days have you been away from your job this year for conferences, not counting this conference? None

Do you have sufficient funds in your budget for this conference? Yes

Write a short statement explaining the public purpose that will be met by your attendance at this conference: (continue on the back if necessary.)

Required by State in order to have educational requirements for the year.  
\_\_\_\_\_  
\_\_\_\_\_  
\_\_\_\_\_  
\_\_\_\_\_  
\_\_\_\_\_

APPROVED

12-11-2018

*L.A.*

Lee Ann Jones,  
County Judge

# PANOLA COUNTY OFFICIAL/EMPLOYEE REQUEST FOR ATTENDANCE AT A CONFERENCE

NAME: Kimberly Gray

POSITION: Deputy

DEPARTMENT: Sheriff's Dept.

DATE: 12-3-18

CONFERENCE: TCOLE Simplified

LOCATION: Henderson

DATES: 12-4-18 to 12-4-18

NUMBER OF DAYS OUT OF OFFICE FOR THIS CONFERENCE: 1

Does the conference meet your educational requirements for the year? No

If not, how much of your requirements will be met by this conference? 5

How much of your requirements have been met already, not counting this conference?

\_\_\_\_\_

How many days have you been away from your job this year for conferences, not counting this conference? 1

Do you have sufficient funds in your budget for this conference? Free

Write a short statement explaining the public purpose that will be met by your attendance at this conference: (continue on the back if necessary.)

\_\_\_\_\_

\_\_\_\_\_

\_\_\_\_\_

\_\_\_\_\_

\_\_\_\_\_